

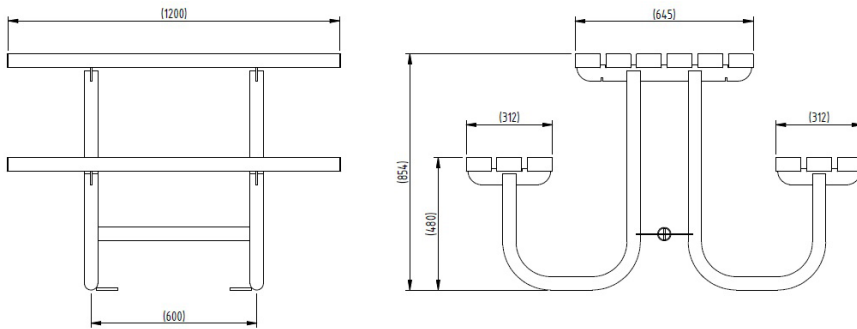

Gretton Picnic Table 1200mm Galvanised or Galvanised & Colour



The Gretton Picnic Table is perfect for use in busy public spaces like retail and business parks, and schools. Great value, functional, low maintenance and robust. Manufactured from galvanised mild steel, this will complement any site, looking good for many years with only minimal maintenance.

The Gretton Picnic Table is supplied in galvanised mild steel. Galvanised and powder coated is an optional extra (RAL number must be stated at time of order).

Available Bolt down only.



| <u>Part Number</u> | <u>Description</u> | <u>Weight (kg)</u> |
|--------------------|---|--------------------|
| 138 117 120 | Gretton Picnic Table, Galvanised - Bolt Down | 118kg |
| 138 117 121 | Gretton Picnic Table, Galvanised & Colour - Bolt Down | 118kg |

Product details

- Table - 1200mm x 645mm x 854mm (length x width x height)
- Seat - 1200mm x 312mm x 480mm (length x width x height)
- Overall width - 1269mm
- Complete with plastic end caps
- Each picnic table requires 4 x 12mm bolts

Installation & use

Supplied fully welded for easy installation on site.
Bolt down versions require bolting to an appropriate concrete surface by means of 12mm bolts.
These products are guaranteed for 12 months (if installed and used correctly).

